

REV	NO.	DATE	DESCRIPTION

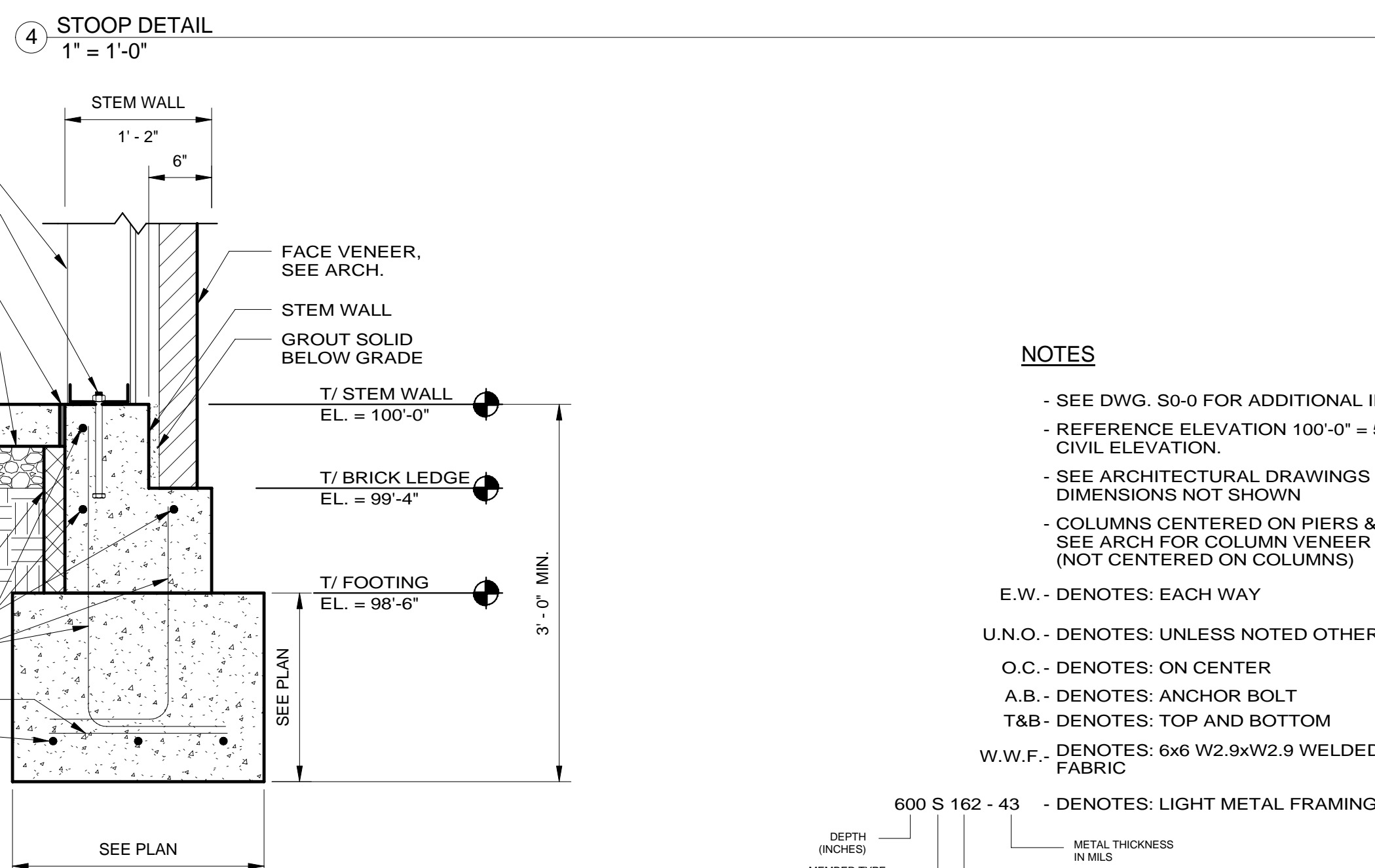
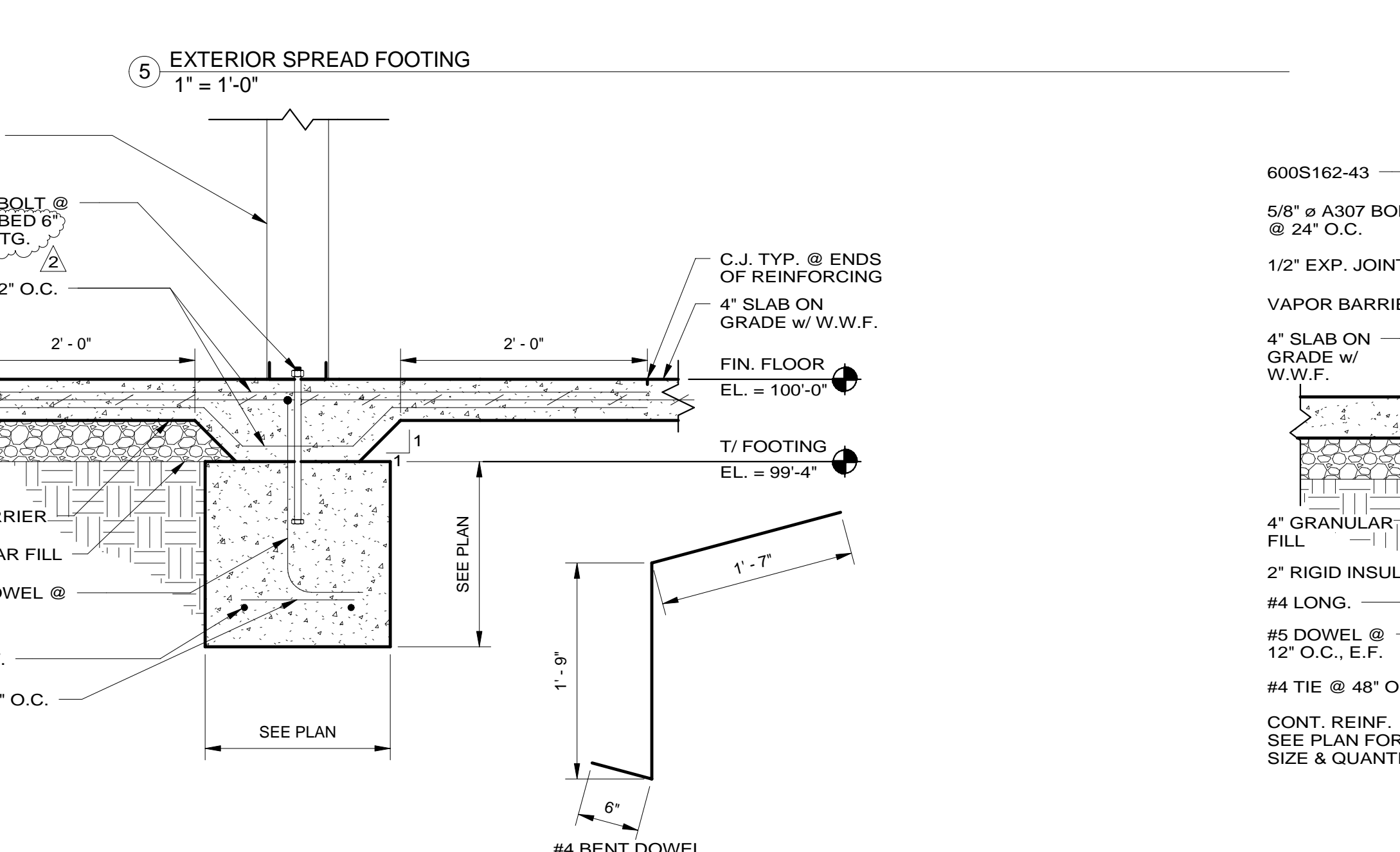
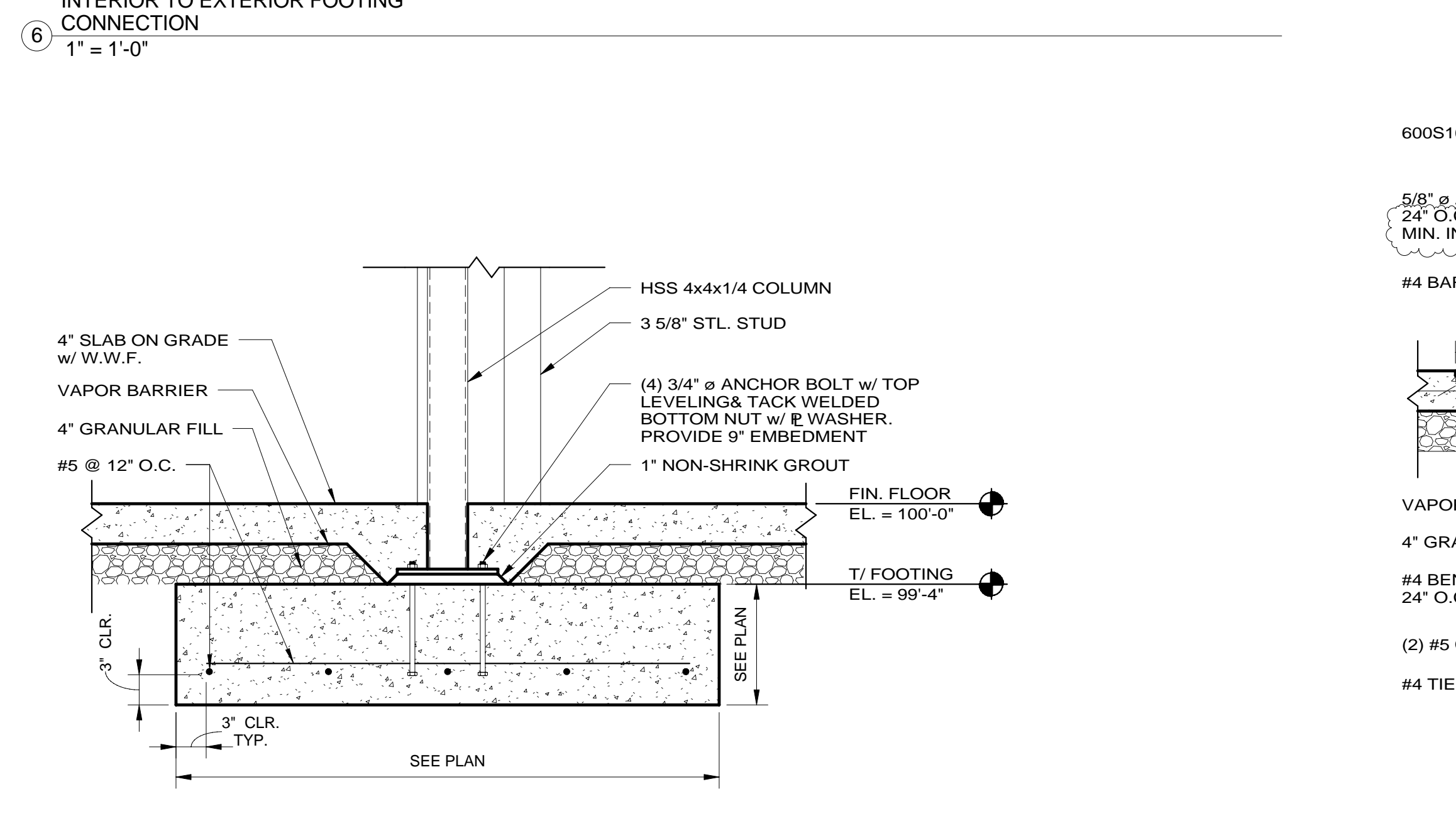
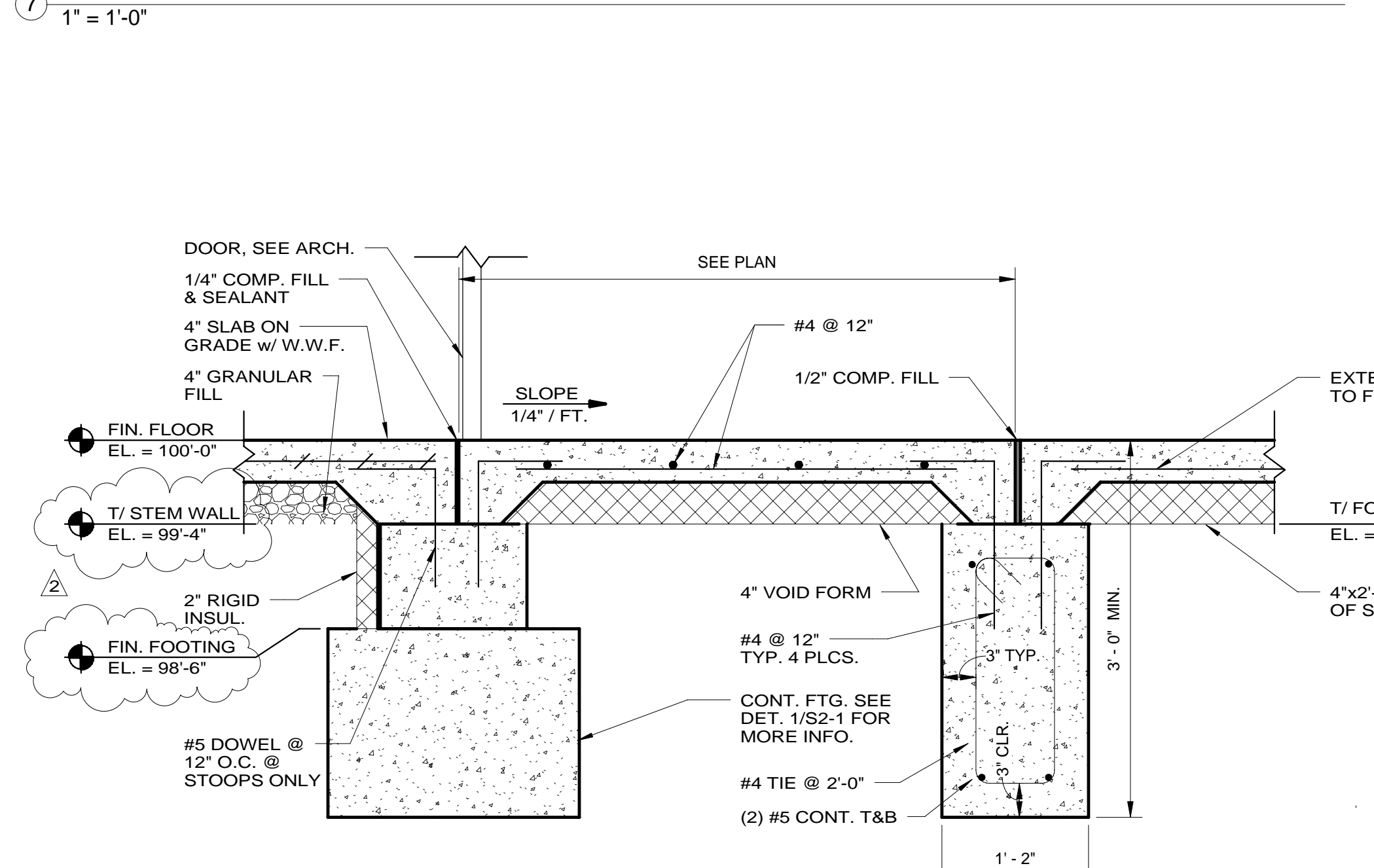
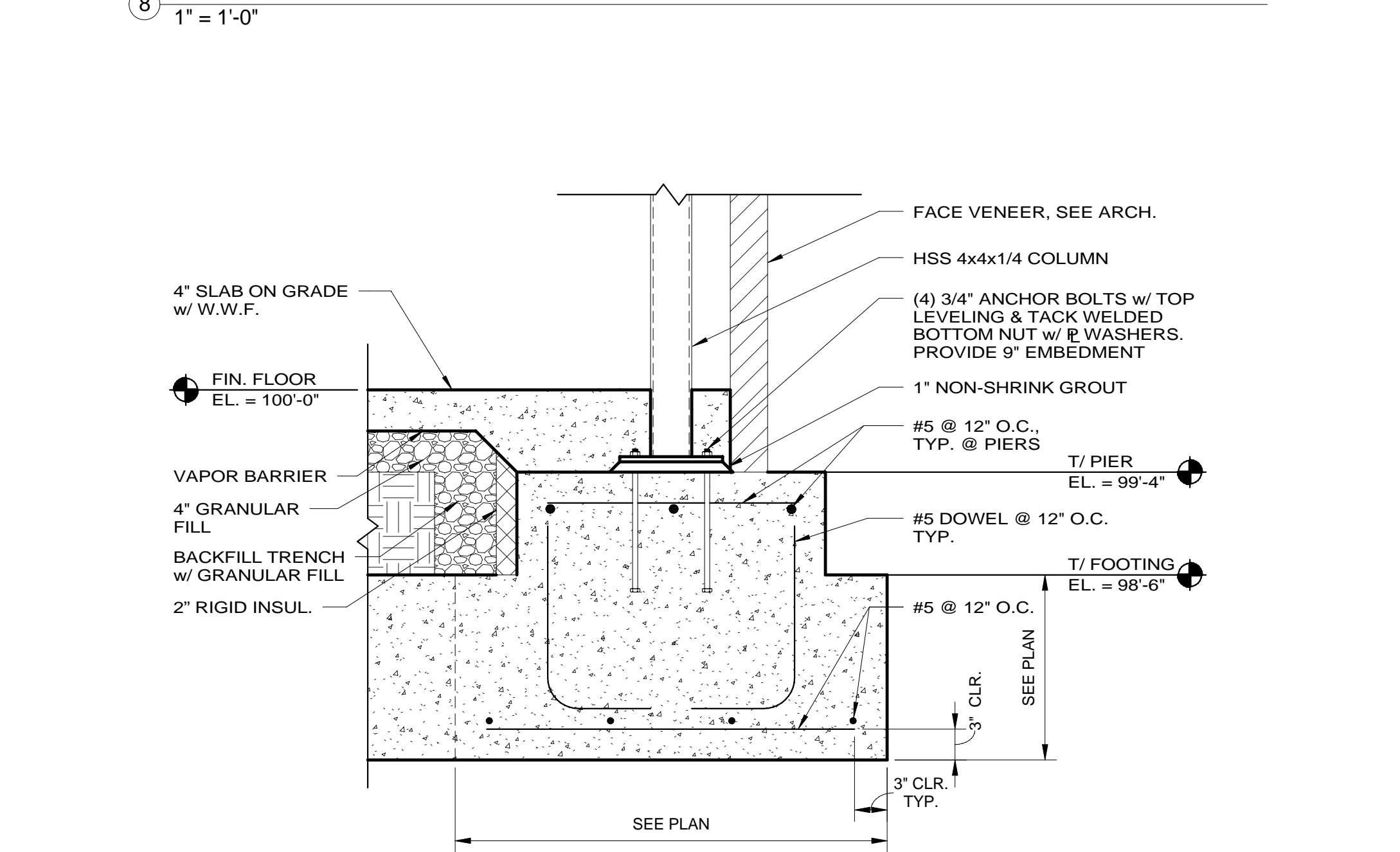
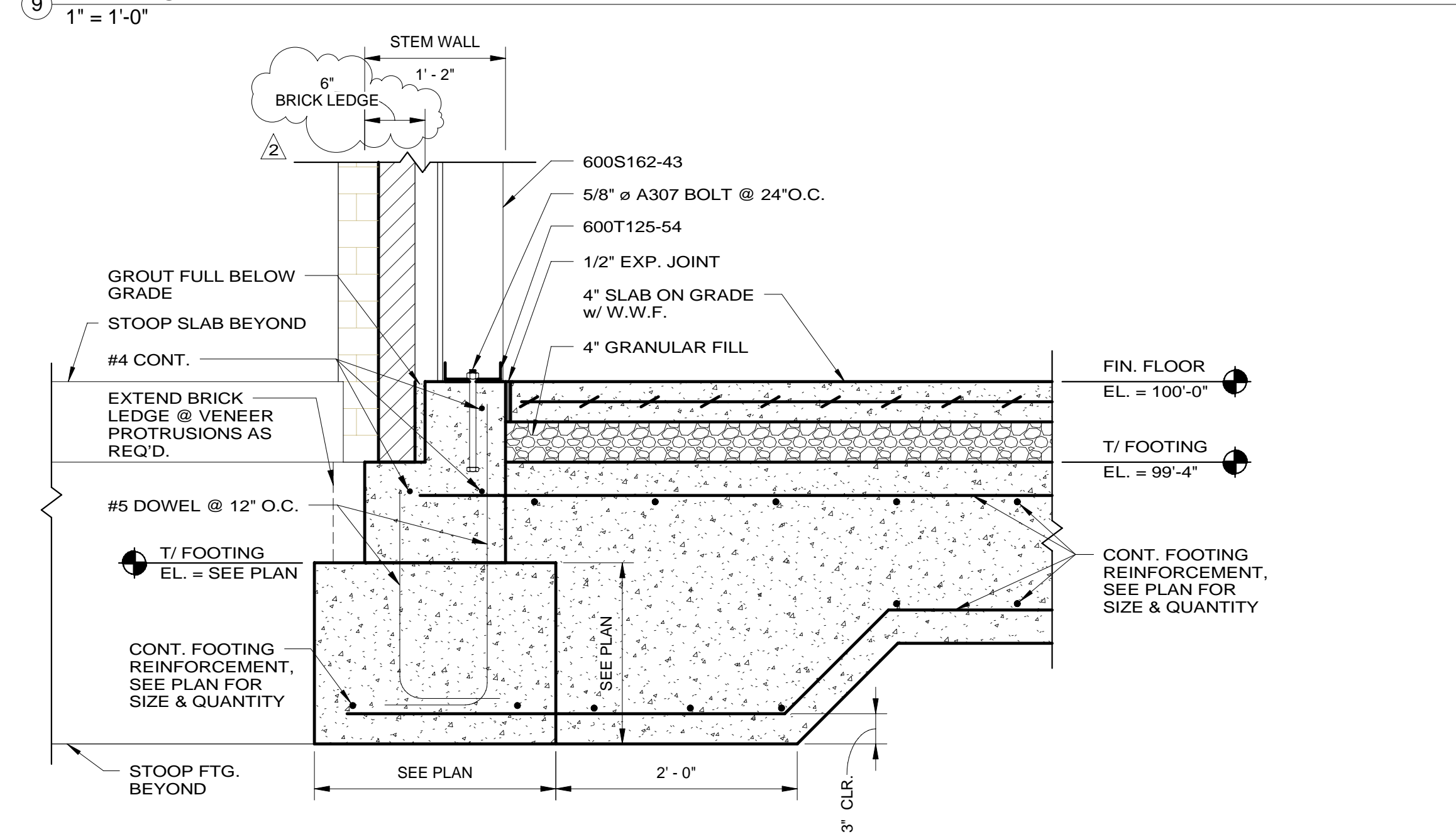
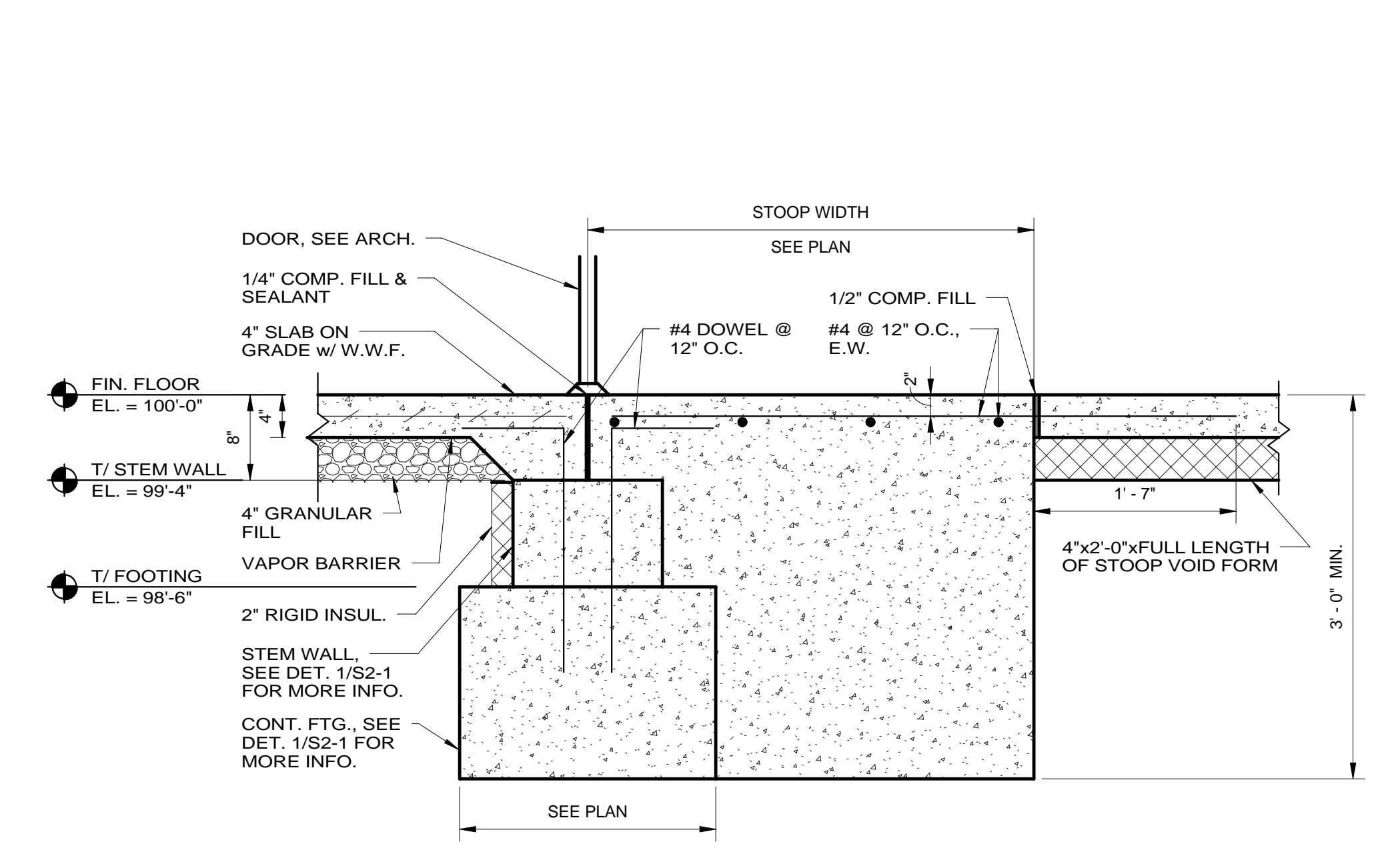
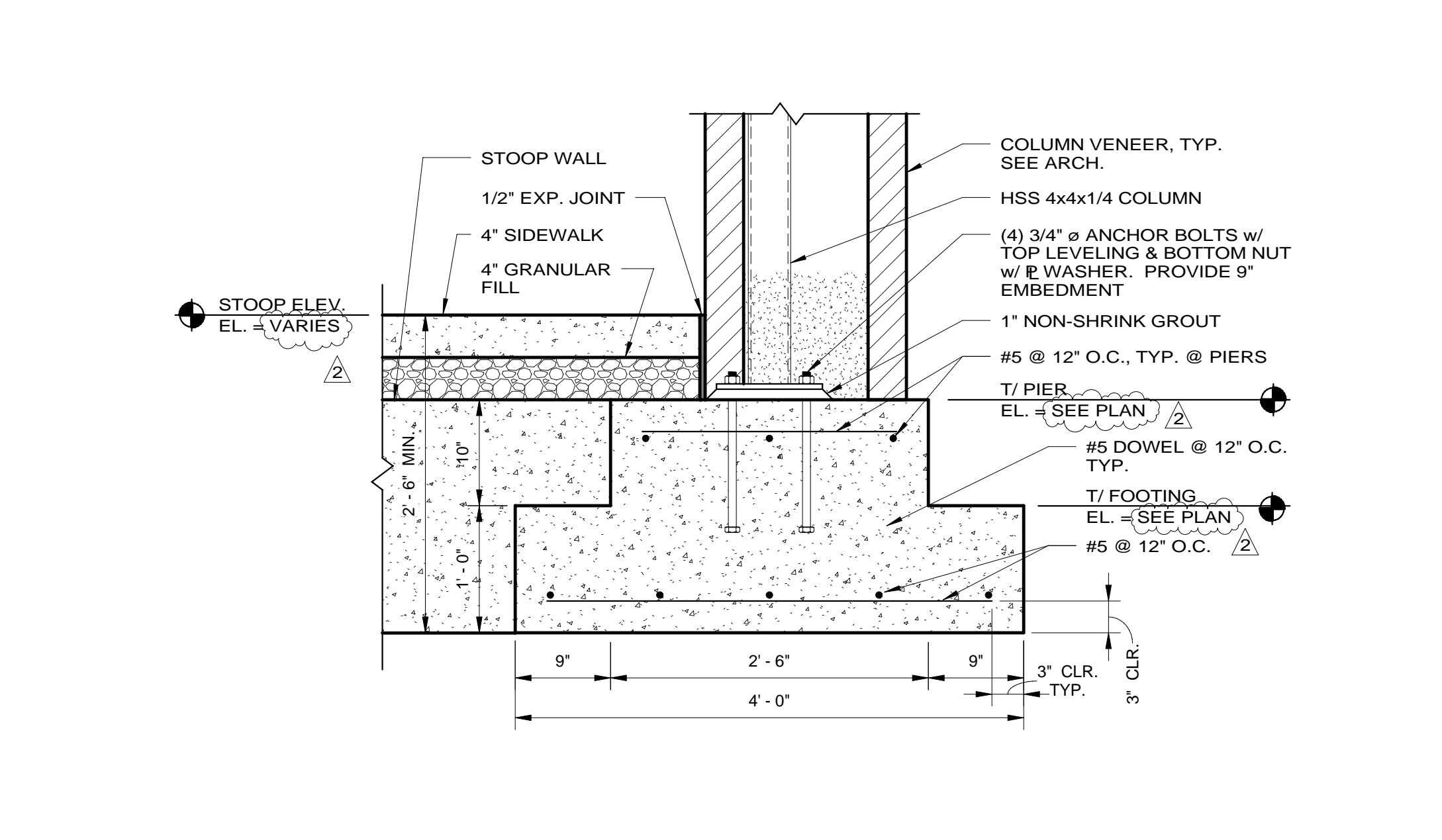
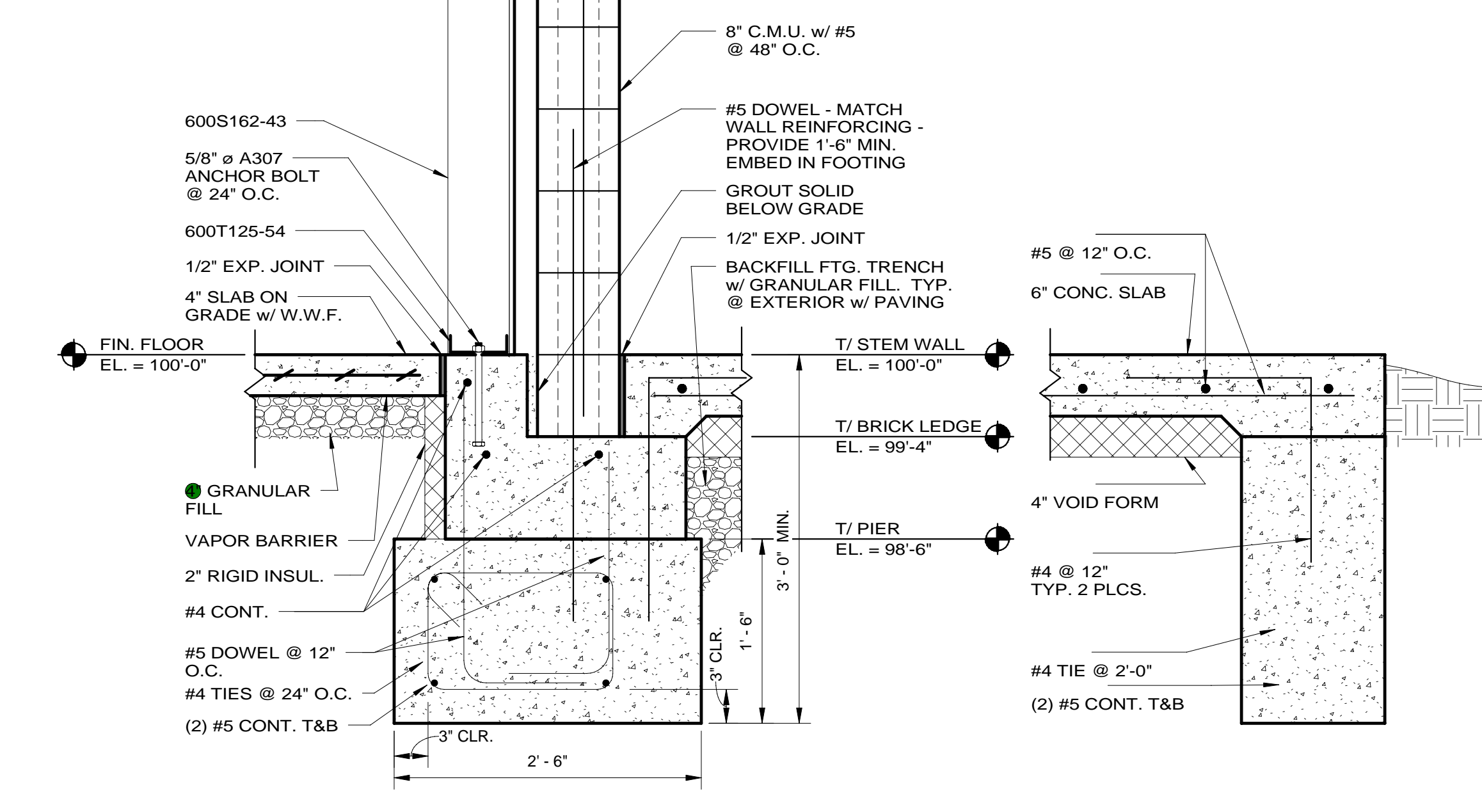
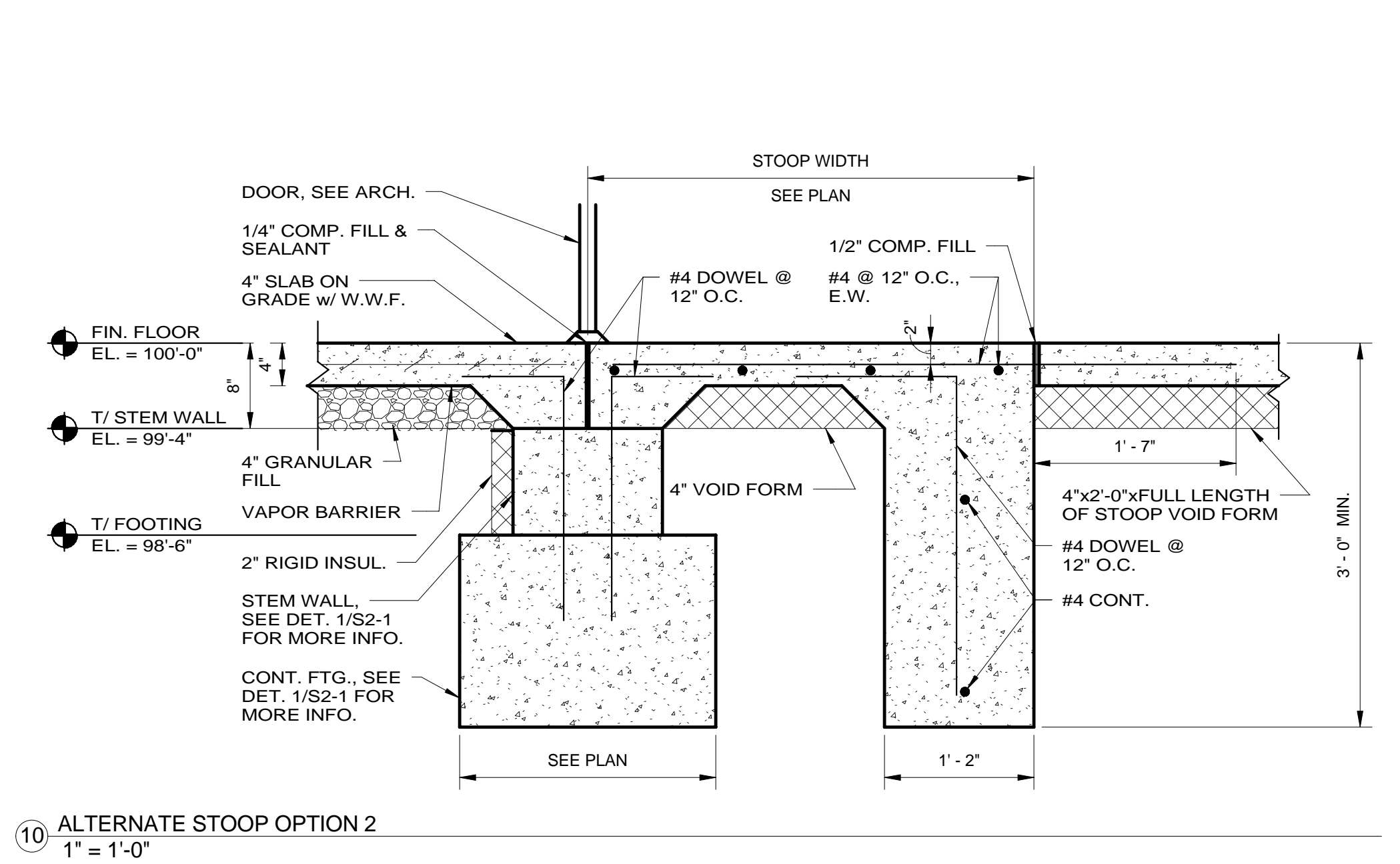
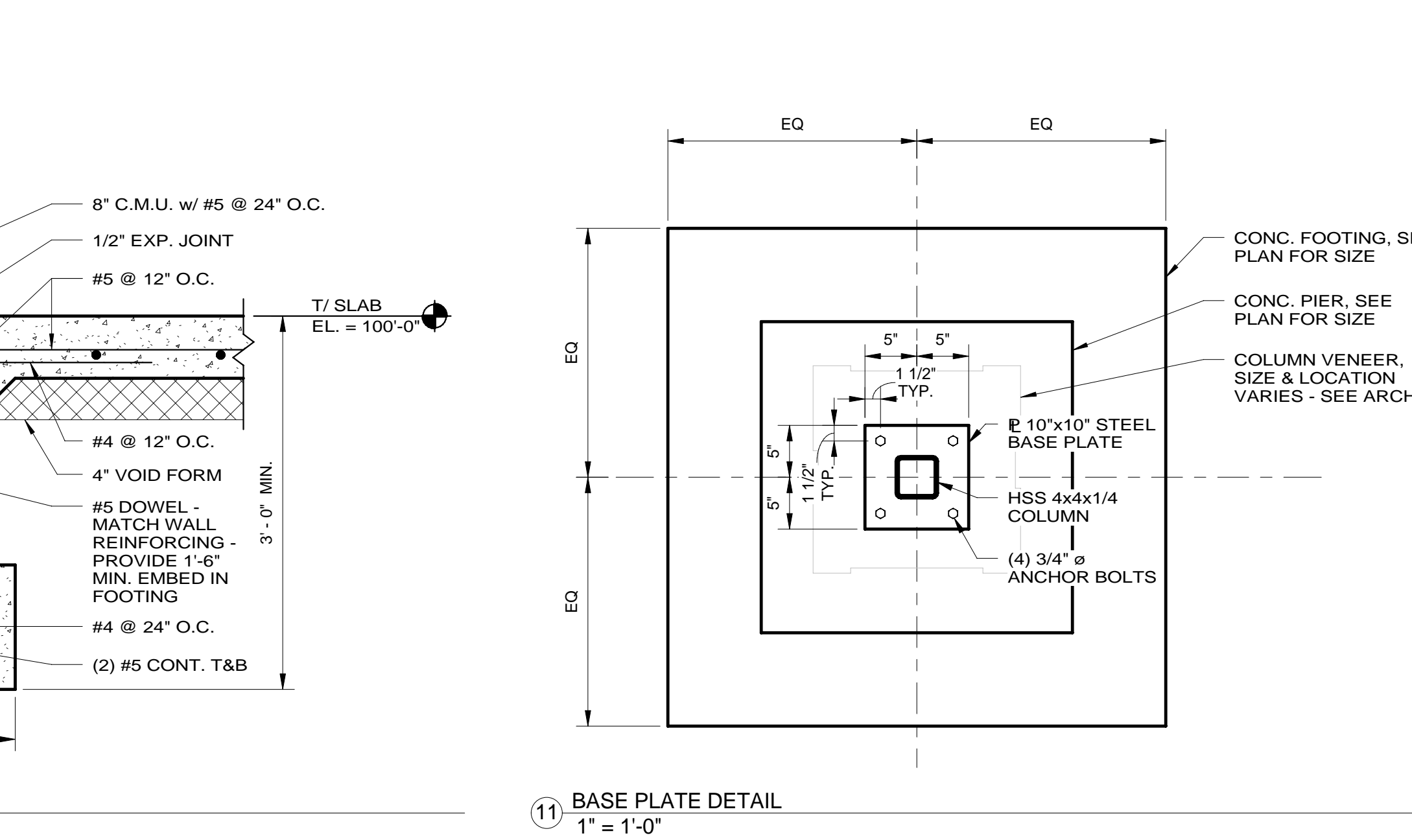
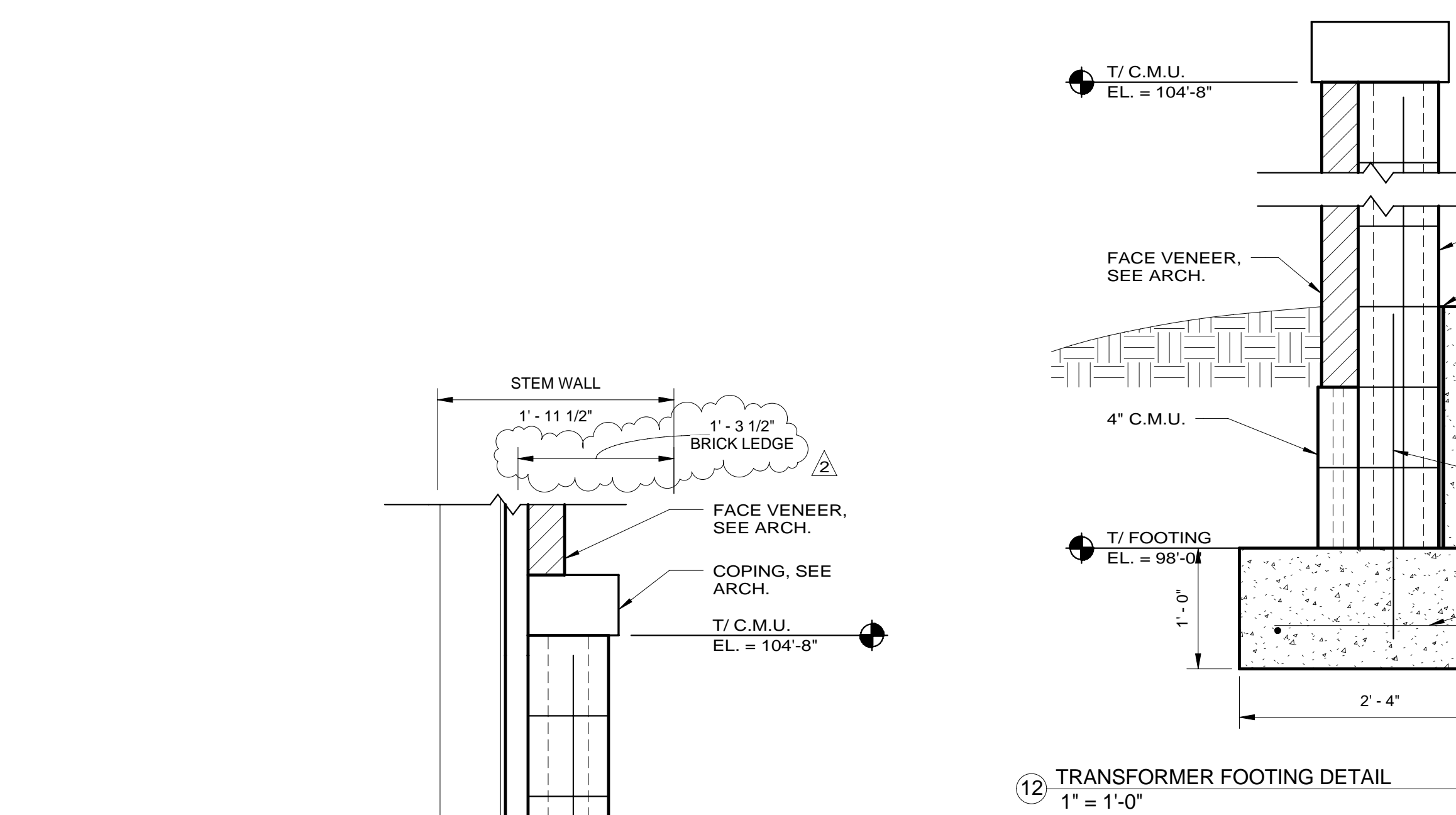

- NOTES**
- SEE DWG. S0-0 FOR ADDITIONAL INFORMATION.
  - REFERENCE ELEVATION 100'-0" = 556.50' CIVIL ELEVATION.
  - SEE ARCHITECTURAL DRAWINGS FOR BUILDING DIMENSIONS NOT SHOWN.
  - COLUMNS CENTERED ON PIERS & FOOTINGS. SEE ARCH FOR COLUMN VENEER LOCATIONS - (NOT CENTERED ON COLUMNS).
  - E.W. - DENOTES: EACH WAY
  - U.O. - DENOTES: UNLESS NOTED OTHERWISE
  - O.C. - DENOTES: ON CENTER
  - A.B. - DENOTES: ANCHOR BOLT
  - T&B - DENOTES: TOP AND BOTTOM
  - W.W.F. - DENOTES: 6x6 W2.9xW2.9 WELDED WIRE FABRIC
  - 600 S 162 - 43 - DENOTES: LIGHT METAL FRAMING