

no.	description	by	date

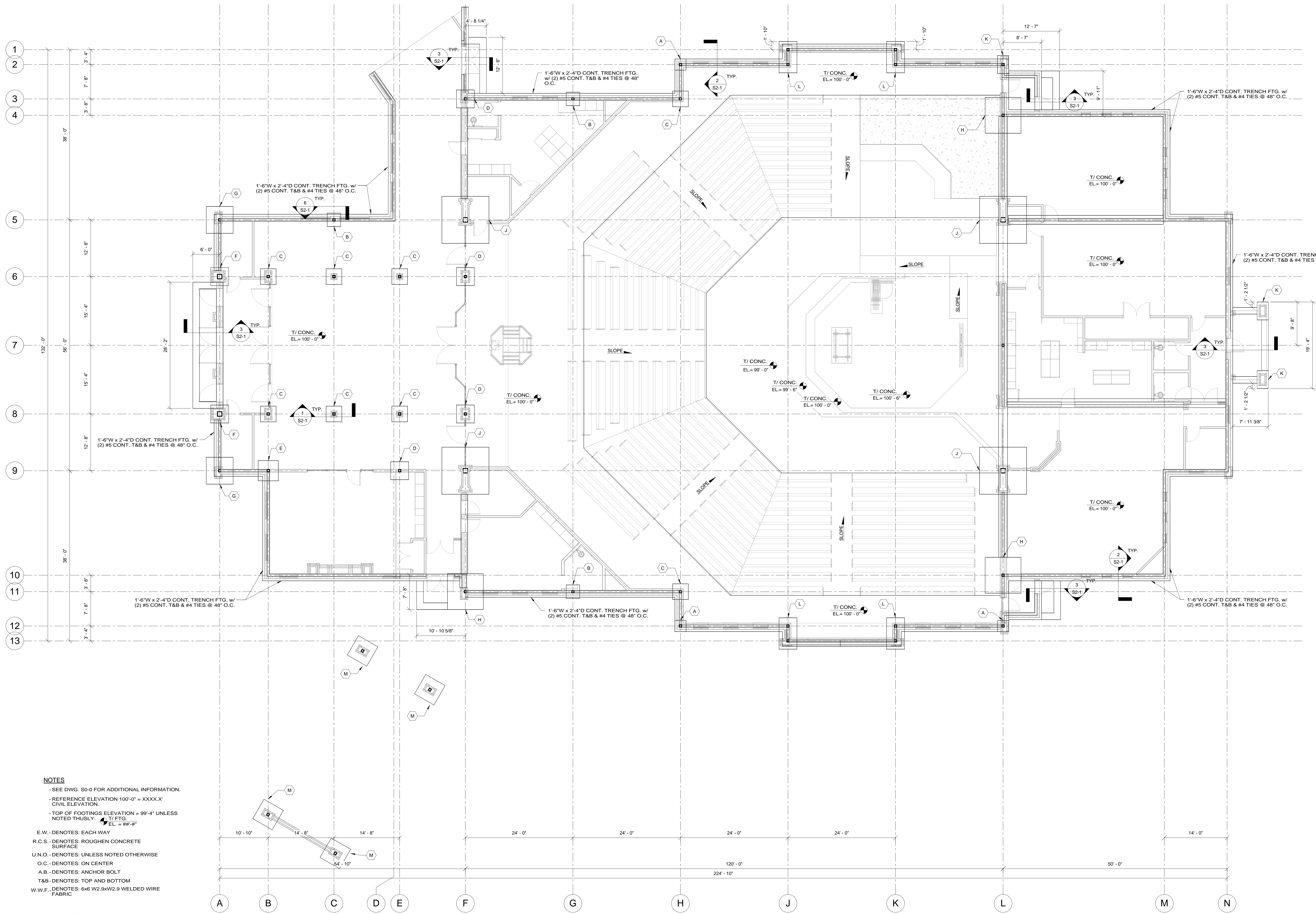

- NOTES**
- SEE DWG. S0-0 FOR ADDITIONAL INFORMATION.
 - REFERENCE ELEVATION 100'-0" = XXXX' CIVIL ELEVATION.
 - TOP OF FOOTINGS ELEVATION = 99'-4" UNLESS NOTED THUSLY: $\frac{1}{2}$ FTG. EL. = ##'-##"
 - E.W. - DENOTES: EACH WAY
 - R.C.S. - DENOTES: ROUGHEN CONCRETE SURFACE
 - U.O. - DENOTES: UNLESS NOTED OTHERWISE
 - O.C. - DENOTES: ON CENTER
 - A.B. - DENOTES: ANCHOR BOLT
 - T&B - DENOTES: TOP AND BOTTOM
 - W.W.F. - DENOTES: 6x6 W2.9xW2.9 WELDED WIRE FABRIC

1 FOUNDATION PLAN
1/8" = 1'-0"